

MODEL H-3 SERIES

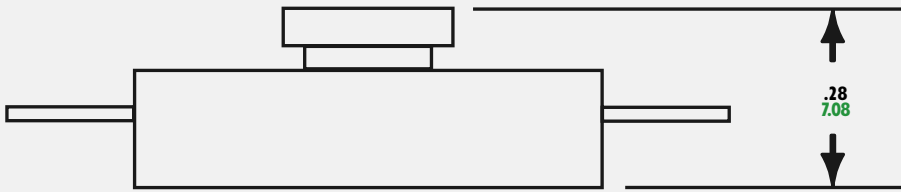

MODEL H-3

SIDE VIEW



TOP VIEW

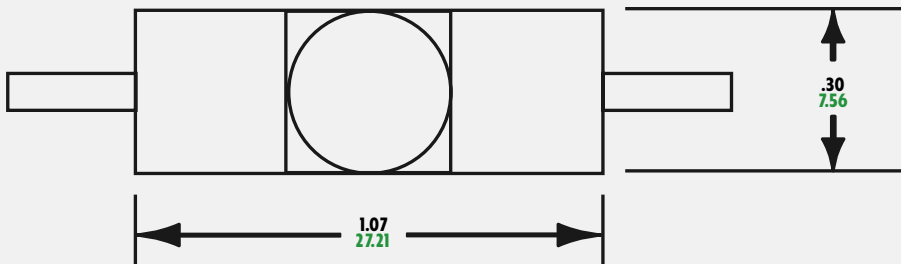

METRIC DIMENSIONS ARE IN MM (SHOWN IN GREEN)

Copyright 2006, Portage Electric Products, Incorporated, all right reserved

A Snap Action Thermal Control that operates as a high limit single operation (non-resettable) type control. This unique device has a phenolic resin case which isolates it from the electrical circuit. This single operation thermostat performs like a thermal fuse with the reliability of a 100% tested bimetallic thermal control.

FEATURES

- Snap action device; quick make/quick break switching action.
- Single operation type device. The reset temperature is less than -35°C . This prevents the thermostat from resetting under normal operating conditions.
- Phenolic resin case isolates the device from the electrical circuit and is suitable for use in high temperature applications.
- Can be mounted directly on a heated surface.
- Preset calibration temperature, not adjustable in the field.
- Opposite end termination allows for flexibility of installation.
- Factory installed lead wires or terminals available -consult factory.

CONTACT RATINGS

- 10 amps/120/240 volts AC resistive
- CUL, VDE -pending

CALIBRATION TEMPERATURE RANGE

- Available with nominal calibration temperatures from 50°C to 230°C .

We come through when the heat is on™



Pepi®

Portage Electric Products, Inc.